

2024-09
NEX·U.® FLUID MONITORING SYSTEM



NEX·U.
®
FLUID MANAGEMENT SYSTEM

FLUID MANAGEMENT SYSTEM

**FOR INCREASED PROFITABILITY IN
LIGHT & HEAVY VEHICLE WORKSHOPS**

MANUFACTURING AND DEVELOPMENT WITH THE LATEST TECHNOLOGY

 www.eurolube.com

FIVE QUICK FACTS

1. Income loss due to incorrect stock control of fluids is often neglected
2. All workshops have unaccounted fluid loss
3. Average fluid loss is about 10 %
4. When the fluid loss is discovered it has already affected income
5. Better control of fluids leads to higher profit

WHY DO YOU NEED A FLUID MONITORING SYSTEM?

Why are not oil and expensive fluids handled as other spare parts?

- Can YOU be sure that your current system correctly invoices every litre of oil?
- Example: a workshop consumes 3000 litres of oil per month. Based on a sales price of € 25/litre the yearly turnover is € 75 000.
- The maximal profit will only occur IF all oil is accounted and invoiced for.
- This example highlights that every litre of oil that is not invoiced is a loss of € 25.

EXAMPLE CALCULATION

Calculation example based on 3000 litres oil/year

Estimated oil loss	Oil loss	Lost income/year
5 %	150 L	€ 3 750
10 %	300 L	€ 7 500
15 %	450 L	€ 11 250

WHAT DO YOU GAIN WITH A FLUID MONITORING SYSTEM?

QUALITY ASSURANCE

Vehicle is filled with correct fluid as specified for maximum performance.

INCREASED PROFIT

Get paid for the correct volume dispensed.

ENVIRONMENTAL SECURITY

Reduces risk for spillage and leakage as system is not pressurized when it is not in-use.

SECURITY

Unauthorized dispense eliminated. Only active authorized work order and PIN are valid for dispense.

ENVIRONMENTAL BENEFIT

Reduces overconsumption as vehicle is filled with manufacturer's specified fluid and volume.

CORRECT STOCK VALUE

Complete control of stock in tanks and drums (tank sensor required).

INCREASED EFFICIENCY

Dispensed volume is automatically registered on the work order.

OPTIMIZED PROFIT

Top-ups are registered and invoiced.

SHORT ROI

Short time to reach profit of total investment.

ADMINISTRATION BENEFITS

DMS/ERP INTEGRATION

Before dispense of fluid can start, the work order must be validated in the system. After dispensing fluid, the transaction data is automatically sent and added to the invoice. We have developed integrations to about 140 different DMS/ERP systems worldwide. This means that we already have many DMS-connections that we can deliver for immediate implementation and operation.

CONTROL OF FILLINGS

All fluids are registered and saved safely in a database.

CONTROL OF STOCK LEVELS

Automatic level sensors measures and updates tank volumes. If automatic sensors are not used, tank levels are calculated by subtracting the volumes dispensed in the system.

EMAIL MESSAGE OF STOCK LEVELS

Automatic email reporting at set alarm levels, e.g. to store manager or oil supplier.

MANAGEMENT AND REPORT DATA

Information such as which user dispensed fluid and fluid consumption per period can be reported.



ADVANCED TECHNOLOGY

WIRELESS FLEXIBILITY

Data can be transferred wirelessly between system components, eliminating the need for long and/or complicated cabling.

Easily add new components as your needs grow.

The system uses existing Wi-Fi® networks, simplifying installation. No need for special, customised network components.

HARD-WIRED RELIABILITY

A constant and reliable power source to operate the solenoid valves that control the fluid flow.

No batteries to change.

Wired communication to avoid interference that can occur during wireless data transmission.

VARIOUS FLUIDS SUPPORTED

We have a wide range of pumps and measuring units in different materials and pressure classes such as aluminium, stainless steel and PVC. This enables us to handle many different liquids such as

- Oils, heavy and light
- Chemicals such as washer fluid, AdBlue®
- Grease

MODULE BASED COMMUNICATION

The system communicates internally on its own network loop, eliminating the risk of external interference.

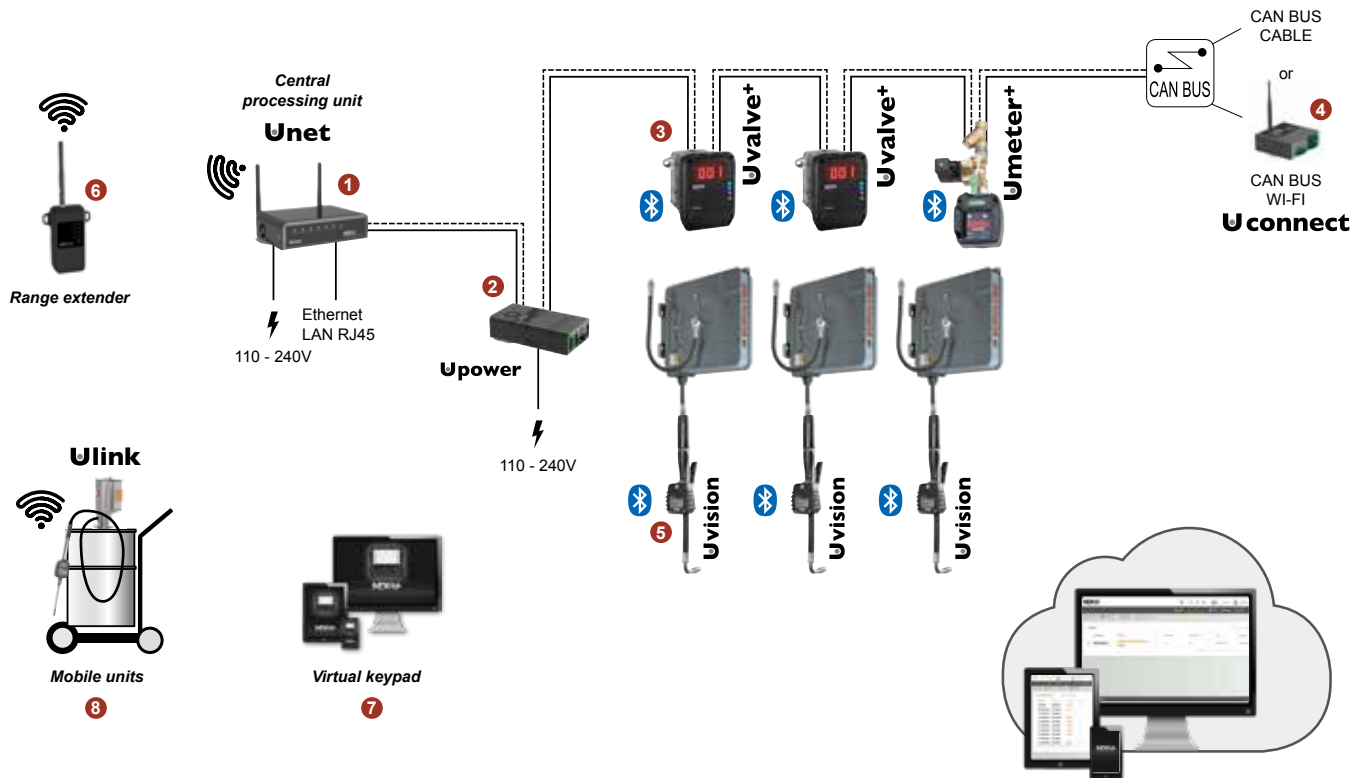

POS	PART NO	DESCRIPTION
1	53802	NEX·U·® U-net Pro Central processing unit with wireless capabilities
2	53826	NEX·U·® U-power Power supply 75W
3	53850	NEX·U·® U-valve Flow control unit with Bluetooth®
4	53881	NEX·U·® U-connect CAN bus to Wi-Fi converter
5	53830	NEX·U·® U-vision Hand-held display for control valve
6	53804	NEX·U·® PRO Extender incl. power cable
7	53801	NEX·U·® Virtual keypad license
8	10572	NEX·U·® U-link Wireless digital handmeter with 90° hose and manual non-drip

READ MORE ON OUR WEBSITE

Follow the link with your mobile phone or visit www.eurolube.com/en/nexu to learn more about the system and its modules. You can also download catalogues and read about our ongoing and completed customer projects.



EUROLUBE EQUIPMENT

by Alentec & Orion AB, Grustagsvägen 4, SE-138 40 Älta, Sweden

EMAIL eurolube@alentec.se

PHONE +46 (0)8-747 67 10

FAX +46 (0)8-715 20 74

www.eurolube.com